



PARTNERS

OF THE SAANICH PENINSULA HOSPITAL & HEALTHCARE FOUNDATION

SUMMER 2025

[f](#) [@](#) sphf.ca

**A MESSAGE
FROM OUR CEO**

**ACUTE CARE
RENOVATION
CAMPAIGN UPDATE**

**PHYSICIAN
ASSISTANTS ARE
TRANSFORMING
EMERGENCY CARE
AT SAANICH
PENINSULA HOSPITAL**

MEET THE PAs AT SPH

**INVESTING IN
EDUCATION**

WAYS YOU CAN GIVE

**VENITA ROSS LEAVES
A LASTING GIFT TO
HER COMMUNITY**

OUR MISSION

To provide up-to-date facilities, innovative programs, and proactive solutions, to support the health, wellness, and sustainability of the Saanich Peninsula and the Southern Gulf Island communities.



Saanich Peninsula Hospital
Physician Assistants
Kylie Shaughnessy
and Fred Bai



Partners is produced by the Saanich Peninsula Hospital & Healthcare Foundation.

Contact us:

Hospital Office:

2166 Mt Newton X Rd.
Saanichton, BC V8M 2B2
Ph: 250-652-7531

Sidney Office:

A2-9769 Fifth St
Sidney, BC V8L 2X1
Ph: 250-656-2948

sphf.ca

f @sphf.ca

@sphfoundation

Heather Edward, CEO
Ph: 250.656.2948

Moving? If you have moved, or are moving, please let us know and we will make appropriate changes to our mailing records.

If you would prefer to receive this newsletter by email to save mailing costs and trees, please email us to let us know: info@sphf.ca



A Message from our CEO

Heather Edward, CEO

On behalf of everyone at Saanich Peninsula Hospital and the Foundation, I would like to extend our deepest gratitude to you, our generous donors and community supporters. Your kindness and commitment make everything we do possible.

Thanks to your incredible support, the Acute Care Unit campaign is nearing completion. By the end of this campaign, our community and donors will have raised \$15 million; AMAZING! This transformative project will modernize a 47 year old ACU unit - a vital part of our hospital, ensuring patients receive care in a safe, comfortable, and welcoming environment for decades to come.

The impact of your generosity goes beyond bricks and mortar. It touches every patient who walks through our doors and every healthcare professional who dedicates themselves to providing exceptional care. Your gift helps elevate care for every patient and contributes to an even better workplace for the staff who make it possible. Together, we are building a healthier future for our community. Thank you for standing with us and making a difference.

With sincere appreciation,

Heather Edward
CEO, Saanich Peninsula Hospital & Healthcare Foundation ■

Every gift makes a difference

Let's complete this transformation - for our hospital, our loved ones, and generations to come.

To donate, use the tearaway form at the back of this newsletter, visit sphf.ca, or call **250-656-2948**.



Acute Care Renovation Campaign Update

"We're pleased to share Island Health is actively working on the designs and is preparing to break ground near the end of summer 2025."

Thanks to your incredible generosity, we're proud to share the Acute Care Unit (ACU) Campaign has reached an exciting milestone - we've raised \$14.6 million of our \$15 million goal!

Renovating the ACU at Saanich Peninsula Hospital is one of the most important investments in our community's healthcare future. After nearly five decades of service, the unit is in urgent need of modernization to meet today's standards of care and provide a safer, more comfortable environment for patients, families, and staff.

We're pleased to share Island Health is actively working on the designs and is preparing to break ground near the end of summer 2025. Island Health has assembled an advisory committee to ensure the renovated space reflects the real needs of the doctors, nurses, and staff at SPH, as well as the patient.

The renovated unit will offer improved privacy, better infection control, more efficient care spaces, and enhanced support for staff - all designed to support the exceptional level of care our hospital is known for.

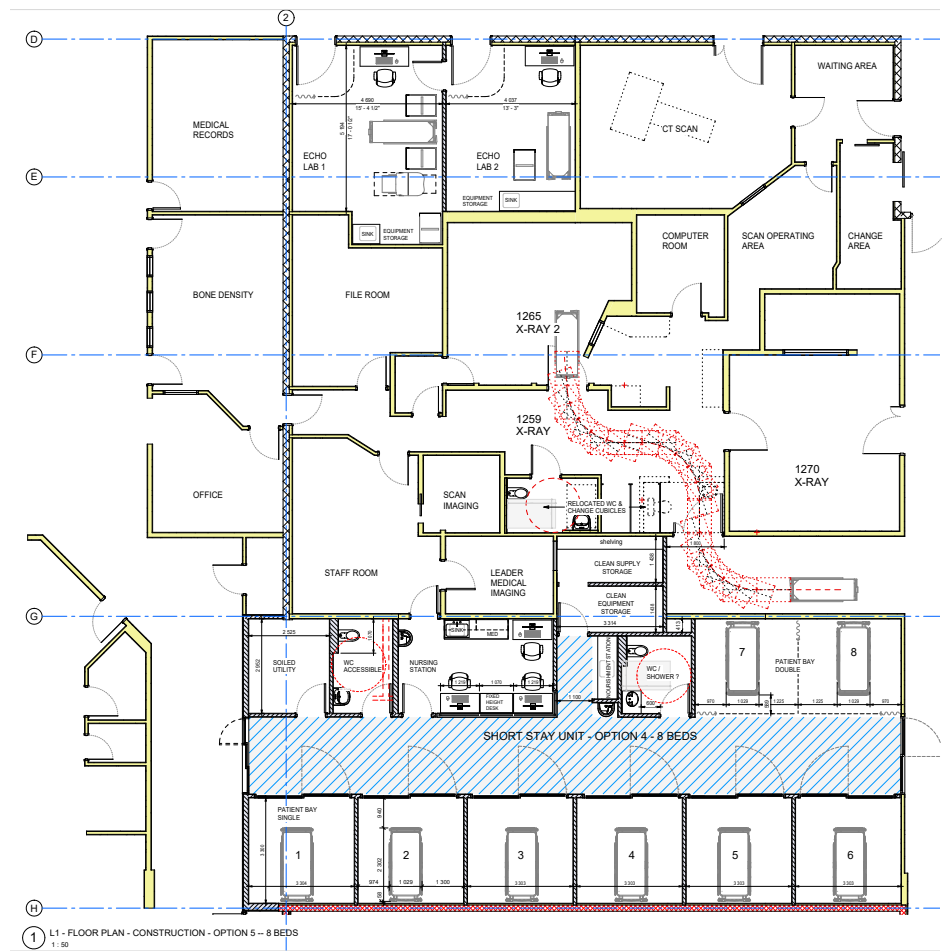

Designed by Sorin Birliga Architect. These draft plans reflect current concepts and are still in development.

With just \$400,000 left to raise before the campaign ends this September, you can help us cross the finish line.

Visit sphf.ca to learn more about the campaign and how you can support local healthcare. ■

A Provincial First in Action:

Physician Assistants Are Transforming Emergency Care at Saanich Peninsula Hospital

In early 2025, Saanich Peninsula Hospital made provincial history by introducing Physician Assistants (PAs) into its Emergency Department as part of a two-year pilot program. This program is the first of its kind in British Columbia. The initiative is already showing strong early results and benefits. By addressing physician shortages and enhancing team-based care, the program is helping to strengthen emergency services for the Saanich Peninsula community.

This innovative program is made possible in part thanks to support from the Saanich Peninsula Hospital & Healthcare Foundation, which has committed to funding a retention incentive bonus and professional development component to help support highly qualified Physician Assistants.

PROGRAM SUMMARY

Three PAs are currently embedded in SPH's Emergency Department, working under the supervision of physicians as part of the broader clinical team. Their responsibilities include assessing patients, performing procedures, interpreting diagnostic tests, and coordinating care. Their integration is helping to reduce wait times, ease physician workload, and improve patient flow, ultimately enhancing the overall experience for patients arriving at the ER.

DR. PAETA LEHN ON THE VISION BEHIND THE PA PROGRAM

When Saanich Peninsula Hospital made the difficult decision to reduce overnight hours in the Emergency Department, the leadership team also searched for creative solutions to sustain care during peak demand.

Physician Assistants, already well established in many parts of Canada, offered a practical and promising answer.

"SPH is an innovative centre," says Dr. Paeta Lehn, Emergency Department Medical Lead. "We saw PAs as a welcome and important resource to help us redirect limited resources to the busiest parts of the day and maintain care standards for the community."

As the first civilian hospital in British Columbia to introduce PAs in a clinical role, SPH is not just filling a need. It is setting a precedent.

"We want to show how PAs can be integrated into emergency departments and perhaps open the door for their role to expand across our healthcare system," says Dr. Lehn.

He emphasizes the essential role that the Foundation played in bringing this vision to life.

"SPHHF financial support was identified as pivotal in this process to attract PA candidates from all over Canada and parts of the US. The funds supplied have allowed our PAs to extend their skills and knowledge, only to further enhance their ability to provide a standard of excellence to our community."

The impact of the PA program has been felt across the department.

"The PAs have been a welcome addition to our ED care team. Not only do they help with our increasing volume, but I personally feel as if they add an element of mentorship that we did not previously have. Patients have been appreciative of the care they have received from our PAs. When they smile, we smile."

Looking ahead, Dr. Lehn hopes this pilot inspires broader adoption.

"I'm proud to be part of this program. I hope it inspires expansion here at SPH and beyond, and I look forward to continuing our work with the Foundation to support this important step forward in healthcare." ■

Meet the Physician Assistants at SPH

Two of SPH's new Physician Assistants share how they're supporting patient care in the Emergency Department.

Fred Bai

"I was drawn to this program by the opportunity to advocate for the Physician Assistant profession in British Columbia. I know there are challenges, but I'm motivated to do my part in helping the province embrace PA's as a way to ease pressure on the healthcare system."

Fred focuses on two areas: applying his clinical skills in the Emergency Department to support timely care, and advocating for the PA role within SPH and the broader community.

A meaningful moment for him came when a patient sent a letter of appreciation to the hospital.

"It reassured me that patients are beginning to understand and value the role of a PA in their care."

He has also seen growing support from colleagues.

"There's more understanding now, and many physicians have expressed satisfaction in working with PAs."



Kylie Shaughnessy

"I was drawn to SPH by its strong sense of community, progressive approach, and the chance to help shape a new model of care in B.C. It's exciting to be part of something innovative."



Kylie has been surprised by how quickly she felt integrated and valued.

"The collaboration, trust, and respect among colleagues has been incredibly rewarding."

Her work includes patient assessments, minor procedures, diagnostics, and care planning. No two days are the same. One memorable moment stood out when a patient, though clinically stable, was still anxious.

"I took extra time to explain everything and answer her questions. She felt heard, and that made all the difference."

Relocating across the country for the role was a leap she's glad she took.

"I feel grounded by the natural beauty of this place and supported by a truly welcoming community."

Her personal motto?

"Small actions, big difference." ■



The SPH Emergency Department is open 7 a.m to 10 p.m. daily for life-threatening or serious health concerns.

The Saanich Peninsula Hospital & Healthcare Foundation is committed to supporting and advocating for the Emergency Department's return to 24/7 service, ensuring our community has access to round-the-clock emergency care close to home.



Investing in Education:

How SPHMF is Supporting Lifelong Learning for Healthcare Excellence

At the **Saanich Peninsula Hospital & Healthcare Foundation**, we believe that investing in people is investing in better care. One of the most direct and impactful ways we support this vision is by funding continuing education and training for hospital staff. Over the past year, the Foundation has proudly funded a range of professional development opportunities that strengthen clinical skills, enhance patient care, and foster a resilient, prepared workforce. Here is a look at some of the programs we've supported:

BASIC ARRHYTHMIA INTERPRETATION

FUNDING: \$500.00

This specialized training provides staff with the ability to interpret ECG strips — a critical skill for those advancing in OR or PACU roles. Enhanced interpretation skills lead to quicker, safer patient assessments.

BSN BRIDGING PROGRAMS: LPN TO RN TRANSITIONS

FUNDING: MULTIPLE GRANTS TOTALING OVER \$38,000.00

SPHMF has supported several Licensed Practical Nurses (LPNs) transitioning to Registered Nurse (RN) roles through institutions like Athabasca University and Camosun College. These programs are essential for stabilizing SPH's RN staffing levels and cultivating a skilled, long-term workforce familiar with our local healthcare community.

TRAUMA AND CRISIS INTERVENTION TRAINING

FUNDING: \$2,494.30

This foundational course in critical incident stress debriefing empowers staff to offer consistent support during and after crises. By embedding debriefing practices into hospital culture, Saanich Peninsula Hospital can improve staff retention, reduce stress-related absences, and create a safer, more supportive environment.

ADVANCED NURSING AND MASTER'S PROGRAM

FUNDING: \$8,957.89

This funding helps a nurse complete an advanced certificate in Leadership for Health Transformation and the final year of a Master of Nursing program. The education will be applied to mentoring staff, improving quality initiatives, and enhancing SPH's leadership capacity.

PROVINCIAL INSTRUCTOR
DIPLOMA PROGRAM

FUNDING: \$6,500.00

This instructor training equips professionals with tools for adult education and curriculum design. It helps SPH maintain high-quality clinical training environments which is particularly valuable for student technologists and new hires.

NATIONAL EMERGENCY
NURSES CONFERENCE AND
CERTIFICATION COURSES

FUNDING: \$4,000.00

By attending the National Emergency Nurses Conference and earning certifications in ACLS, TNCC, and EPIC, staff can bring back cutting-edge knowledge, new protocols, and leadership skills to the Emergency Department, ultimately enhancing team capability and patient outcomes.

INTERNATIONAL NURSING
LICENSE VALIDATION
(BRAZIL TO CANADA)

FUNDING: \$2,938.59

SPHMF supported an Internationally Educated Nurse (IEN) in covering costs related to obtaining Canadian licensure. This funding directly addresses the nursing shortage in BC by adding an experienced, compassionate RN to SPH's staff.

CARDIOLOGY
TECHNOLOGIST PROGRAM

FUNDING: \$10,000.00

SPHMF contributed toward a staff member's enrolment in a cardiology technology program, helping address diagnostic delays and increasing access to timely cardiac assessments in the Emergency Department.

PREREQUISITES FOR
MASTER OF NURSING –
INDIGENOUS WELLNESS

FUNDING: \$1,000.00

This support enabled staff to begin a Master's program specializing in Indigenous Wellness. The knowledge gained will help educate front-line staff and improve culturally sensitive care for Indigenous patients served by SPH.

TUITION FOR PRACTICUM
– REHABILITATION
SUPPORT

FUNDING: \$1,000.00

Support for a rehab assistant's final practicum ensures more staff are trained to help patients maintain and improve physical function — a crucial role in reducing length of hospital stay and promoting recovery.

WOUND CARE
SPECIALIZATION

FUNDING: \$1,435.00

With the rise in complex wound cases, this course ensures Clinical Nurse Educators can assess wounds effectively and support both staff and physicians across acute and emergency care settings. ■



SAANICH PENINSULA HOSPITAL & HEALTHCARE FOUNDATION

SPIRIT GALA

CRIMSON CABARET

PRESENTED BY



OVER 75% SOLD!

BUY YOUR GALA TICKET TODAY

SATURDAY NOVEMBER 15TH, 2025

MARY WINSPEAR CENTRE
DOORS & COCKTAIL RECEPTION 5:30PM

- 3 course dinner
- Complimentary drinks
- Entertainment by *The Haven*

Funds raised will go toward the
Enhancing Surgical Services campaign
at Saanich Peninsula Hospital.



TICKETS \$300

To purchase tickets, learn more about
sponsorship opportunities, or more information

250-656-2948 | sphf.ca/spirit-gala-2025

GALA EVENING SPONSORS

PRESENTING SPONSOR



WINE SPONSOR



CHOCOLATE SPONSOR



FLORAL SPONSOR



ENTERTAINMENT SPONSOR



SILENT AUCTION SPONSOR



COCKTAIL RECEPTION SPONSOR



LIVE AUCTION SPONSOR



VENUE SPONSORS



COMMUNITY SPONSORS



MEDIA SPONSORS



250-656-2948 sphf.ca



Ways You Can Give

Your support plays a vital role in enhancing healthcare on the Saanich Peninsula. Here are several meaningful ways you can contribute:



Donations of Shares

Donating publicly traded securities can be a tax-efficient way to support healthcare improvements.



Return-It Depot

Recycle your return-for-deposit items at Sidney's Island Return-It, account #157, to support the Foundation.



Online Donations

Make a secure donation using your credit card at www.sphf.ca. You'll receive an instant tax receipt via email.



Community Fundraising Initiatives

Organize events or campaigns in your community to raise funds for the Foundation.



Points Cards

Donate your Scene Card points and Air Miles to the Foundation to support our fundraising efforts.

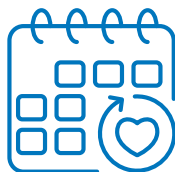

Monthly Giving

Join our community of monthly donors to provide consistent support that makes a lasting impact.



Commerce for Care / Sponsorships

Businesses can partner with us through sponsorships, making healthcare a part of their corporate social responsibility.



By Mail or In-Person

Visit our offices or send a cheque to contribute directly.



Legacy Gifts

Include Saanich Peninsula Hospital & Healthcare Foundation in your estate planning to leave a lasting legacy for future generations.



Donate a Car

Through Donate A Car Canada, you can donate your vehicle, with proceeds supporting SPHFF.

Contact Information

Phone: **250-656-2948**

Email: info@sphf.ca

A2-9769 Fifth Street,
Sidney, BC, V8L 2X1

For more details on each giving option, please visit our Contribute page: sphf.ca/contribute-2

Venita Ross

Leaves a Lasting Gift to Her Community

When Lisa and Ian Banfield moved into their Saanichton home in 1997, they were greeted by a neighbour bearing a “friendship cake.” That neighbour was Venita Ross, a quiet and independent woman whose kind gesture sparked a lifelong friendship.

Venita and her husband John moved to Vancouver Island from Hanna, Alberta, seeking better weather for John’s health. They settled in Saanichton and built a custom home on their subdivided property, which later became known as Venross Place. The name came from a combination of their last name and Venita’s first. After John passed away, Venita stayed in the home and kept to herself, living a life filled with routine, care for her garden, and treasured friendships.

“Venita’s gift was not about recognition. It was about community and compassion.”

Venita had a deeply generous spirit. She supported many causes over the years, including BC Cancer, Saanich Peninsula Hospital, Heart and Stroke, BC Children’s Hospital, BC SPCA, CNIB, and even added the Parkinson’s Society when Ian Banfield’s father was diagnosed. She believed in helping others and always found a way to give.

Though she stayed more private in her later years, Venita’s bond with the Banfields only grew stronger. They describe her as more than just a neighbour; she was a close friend

“She was very caring and funny,” recall the Banfields. “She had a great sense of humour, loved her garden, and was incredibly independent. Even after John passed, she knew where every one of his tools was and kept everything in order. She never needed help.”



Venita Ross, generous Legacy donor

and a constant presence in their lives. She was also deeply connected to her community, even if she preferred to express it quietly.

Venita often spoke fondly of Saanich Peninsula Hospital, referring to it as a “little jewel.” The care John received there in the mid-90s left a lasting impression on her, and when she became ill in 2023, her appreciation for the hospital was reaffirmed.

With no family left, Venita asked the Banfields to act as the executors of her estate. It was a big request, and she was nervous to ask, but her trust in them was strong. One of her final wishes was to leave a legacy gift to the Saanich Peninsula Hospital & Healthcare Foundation.

“She didn’t do it for recognition or praise,” says Ian. “She simply wanted others in the community to receive the same compassionate care she and John experienced. That was what mattered to her.”

For Lisa and Ian, it has been a meaningful experience to help carry out Venita’s wishes. They think about her every day and feel proud to share her story.

“Her legacy shows who she was. She was caring and thoughtful, and this gift truly reflects that.”

Venita’s gift will help ensure that the hospital can continue providing exceptional care to those who need it most. It is a lasting contribution to the community she loved and a reflection of the life she lived.

The Banfields hope others will consider what legacy giving can mean for the causes they care about.

“Non-profit organizations rely on these gifts to continue doing their important work. If a place or cause has made a difference in your life, a legacy gift is a wonderful way to give back.”

“She wasn’t just the lady across the street. She was a great friend and became family.”

Through her quiet generosity and thoughtful planning, Venita Ross left behind something truly special. Her story lives on in the people she touched and the community she helped strengthen. ■



Ian and Lisa Banfield hold photos of Venita and her husband John.



Would you like to learn more about how a legacy gift can support healthcare on the Saanich Peninsula?

Visit our Legacy Giving page at **sphf.ca** or contact our team at **250-656-2948** to start the conversation. Every gift, large or small, can make a lasting difference in our community.

Your support matters more than ever.

Name:

Address:

City:

Postal Code:

Email:

Phone:

Enclosed is my tax deductible gift of:

\$1000 \$500 \$250 \$100 \$50

Other amount: \$

Cheque enclosed Visa Mastercard

Card No.:

Expiry Date:

Signature:

I would like to make a monthly donation of
\$

by: Credit card Void cheque enclosed

I would like to receive occasional email updates and information from the Saanich Peninsula Hospital & Healthcare Foundation.

PLEASE DIRECT MY GIFT TO:

- Current campaign
- Wherever the need is the greatest
- Other: _____

- I have remembered SPHFF in my will
 - I would like info on how to make a gift to SPHFF in my will
- Or contact directly:
email: info@sphf.ca
telephone: **250-656-2948**

All donations of \$20 or greater will receive a SPHFF charitable receipt.
BN 11913 0540 RR0001

Please email me my receipt in lieu of a mailed tax receipt

Donations gratefully received by mail:

Hospital Office:

2166 Mt Newton X Rd.
Saanichton, BC V8M 2B2
Ph: **250-652-7531**

Sidney Office:

A2-9769 Fifth St
Sidney, BC V8L 2X1
Ph: **250-656-2948**

Online donations: www.sphf.ca

Social Media:  @sphf.ca  @sphfoundation

"In accordance with the Province of BC's *Personal Information Protection Act*, the Saanich Peninsula Hospital & Healthcare Foundation collects information required for tax receipting purposes and protects all personal information. No information of a personal nature (other than that required by the Canada Customs and Revenue Agency for tax filing purposes) will be revealed to any outside organization. From time to time the Foundation mails information regarding existing and new fundraising programs. If you would prefer not to receive such mailings, please advise our office. Your donor records are available to you for inspection upon request."

NLSUM25

